



REF: # 12771

PILAR DE LA HORADADA



INFO

:	299.900 €
:	
:	Pilar De La Horadada
:	3
:	2
(m2):	91
(m2):	-
(m2):	33
:	
:	-
:	-



New build homes in Pilar de la Horadada with private pool Modern homes close to the beach Discover this exclusive new build residential complex in Pilar de la Horadada, which offers bungalows just 2.5 km from the beach. Designed for comfort and style, these homes are an excellent opportunity to enjoy life on the Costa Blanca. Spacious and stylish homes This development offers 2 or 3 bedroom homes with 2 bathrooms and private parking. Choose from: Ground floor bungalows with private garden. Top floor bungalows with open terrace. 1 Townhouse with 3 bedrooms and corner plot. Each property is built with high quality materials and modern finishes, including: All properties have private swimming pool. Pre-installation of ducted air conditioning. Aluminium exterior carpentry with thermal break and double glazing. Security entrance door for peace of mind. Aerothermal system for efficient hot water production. Fitted wardrobes in bedrooms. Privileged location in Pilar de la Horadada Pilar de la Horadada is a charming Spanish town in the southernmost part of the Costa Blanca. It offers a vibrant main street with numerous shops, supermarkets, restaurants and picturesque squares. The stunning beaches of Torre de la Horadada and

Mil Palmeras are only 5 minutes away, with fine golden sand and a picturesque promenade. The town also offers well-developed cycle paths and hiking trails, as well as a variety of sporting activities. Convenient access to key destinations Lo Romero Golf Course - 5 km (10 minutes drive). Corvera Airport (Murcia) - 40 km (40 minutes drive). Alicante Airport - 55 km (55 minutes drive). Shopping Centres (La Zenia Boulevard) - 15 km (15 minutes by car). Torre de la Horadada Marina - 3 km (5 minutes drive). Secure your dream home today Don't miss out on this fantastic opportunity to own a brand new home in a prime location. Contact us today for more information and to arrange a viewing.



•

•













7 VIVIENDAS ADOSADAS CON PISCINA

VIVIENDA TIPO A.3
ESCALA 1/100



PLANTA BAJA

ESQUEMA PLANTA BAJA

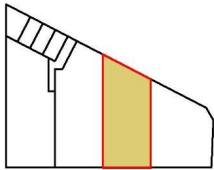

VIVIENDA A.3

Vivienda tipo A.3	
Salón-comedor	28,75 m²
Cocina	7,20 m²
Distribuidor	3,00 m²
Dormitorio 1	11,10 m²
Dormitorio 2	11,45 m²
Cuarto de baño 1	4,40 m²
Dormitorio 3	9,75 m²
Cuarto de baño 2	3,95 m²
Superficies útil interior	79,60 m²

Vivienda tipo A.3	
Jardín/Parking	30,00 m²
Piscina	13,30 m²
Patio	4,15 m²
Superficies útil exterior	47,45 m²
Superficie construida	91,26 m²
Superficie Parcela	146,02 m²





"OUR EXPERIENCE IS YOUR GUARANTEE"