



REF: # 12384

BENIDORM



#### INFO

: 945.000 €

:

: Benidorm

:

:

( m2 ): 79

( m2 ): 108

( m2 ): -

:

:

-

-

Topografía: 2 Dominios

DOMINIO	AREA	USO
DOMINIO 1	1.000,00 m2	Residencial
DOMINIO 2	1.000,00 m2	Residencial
DOMINIO 3	1.000,00 m2	Residencial
DOMINIO 4	1.000,00 m2	Residencial
DOMINIO 5	1.000,00 m2	Residencial
DOMINIO 6	1.000,00 m2	Residencial
DOMINIO 7	1.000,00 m2	Residencial
DOMINIO 8	1.000,00 m2	Residencial
DOMINIO 9	1.000,00 m2	Residencial
DOMINIO 10	1.000,00 m2	Residencial



Magnificent luxury apartment located on the seafront in Benidorm, this one has a privileged location. The house is distributed in an entrance hall, a spacious and bright living dining room, this has direct access to the outdoor terrace, a beautiful open kitchen fully furnished and equipped, 2 bedrooms and 2 bathrooms. This apartment offers us the possibility of easily distributing the interior space, thanks to this, we can have a space which we can use as a dining room, additional living room, an office, among others. The equipment of the house is very extensive, it has: home automation, high energy efficiency equipment, aerothermal energy, underfloor heating, among others. High quality materials have been used for its construction. The urbanization has 2 beautiful swimming pools, beautiful garden areas, gym, social club, tennis court, as well as a long list of facilities.







\*Se informa a todo receptor/lector de esta información comercial que tanto las fotografías, infografías/renders, y/o planos incluidos en esta documentación comercial, no reflejan de manera exacta el resultado final del proyecto, pudiendo la ejecución del proyecto, por razones técnicas, estéticas o de cumplimiento normativa, sufrir variaciones con respecto a lo que reflejan las fotografías, infografías, renders y/o planos incluidos en esta información comercial.

Tipología: 2 Dormitorios

SUPERFICIE (M²)	ÚTILES (M²)	CONSTRUIDA (M²)
ENTRADA	3,7	4,5
PASILLO	2,1	2,6
BAÑO 1	4,7	5,7
BAÑO 2	2,5	3,1
HABITACIÓN 1	15,5	18,9
HABITACIÓN 2	12,1	14,8
SALÓN/COCINA/COMEDOR	24,3	26,6
<b>TOTAL VIVIENDA</b>	<b>64,9</b>	<b>79,2</b>
TERRAZA	22,6	29,6
PROPORCIONAL Z. COMUNES		30,1
<b>TOTAL CON TERRAZA</b>	<b>87,5</b>	<b>138,9</b>





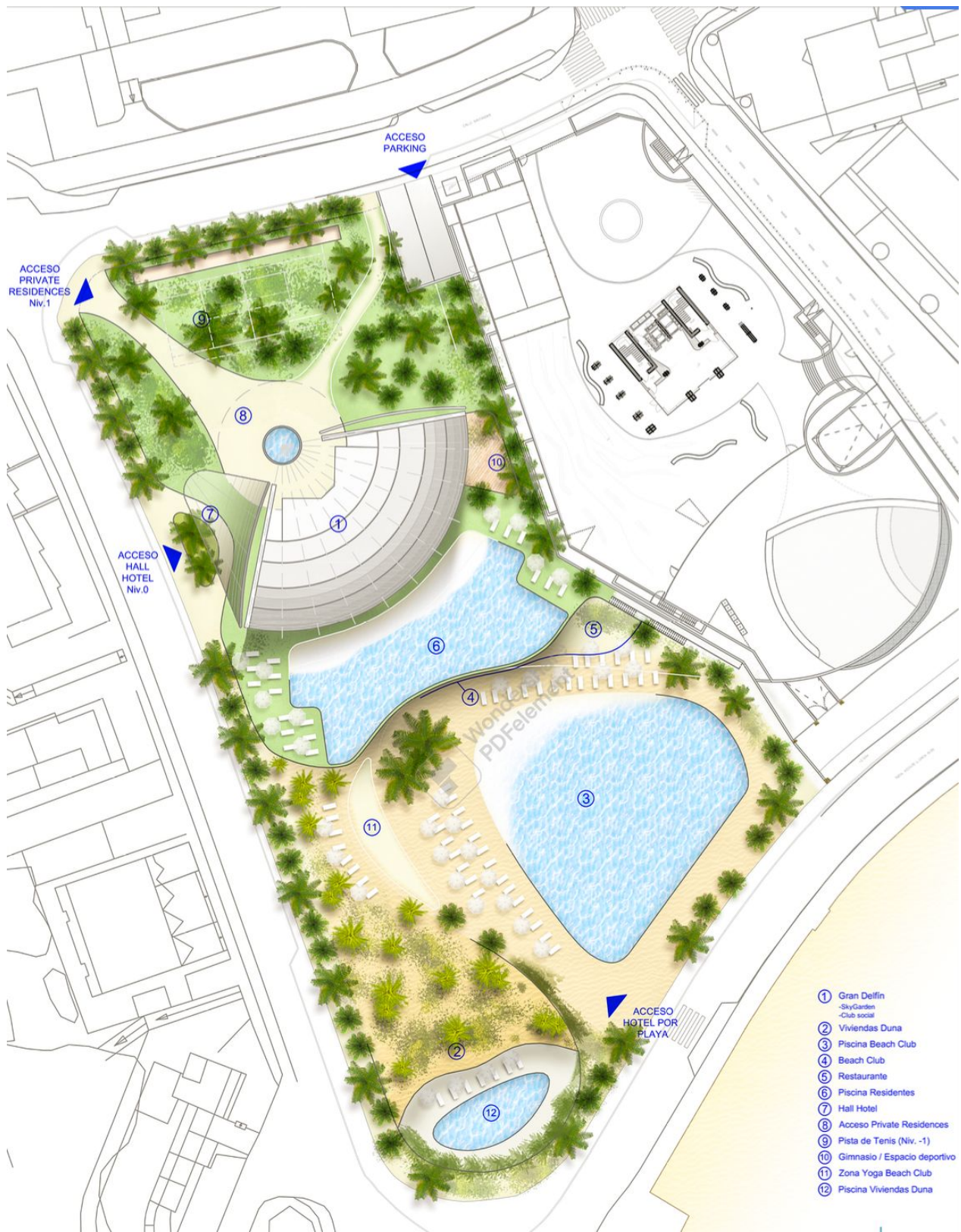



***"OUR EXPERIENCE IS YOUR GUARANTEE"***