



REF: # 10350

CALPE/MORAIRA



INFO

: 680.000 €

:

: Calpe/Moraira

: 3

: 2

(m2): 122

(m2): -

(m2): -

:

:

-

-

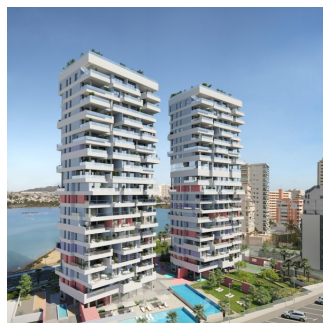

It lives between three seas. The privileged location of the future residential of Isea Views between Las Salinas de Calpe, Plata de Fossa and Playa del Cantall Roig will give you the best views. The excellent layout of the houses of the two towers of the residential, will give you extraordinary views wherever you look. There won't be a corner of your new home that doesn't overlook a naturally Mediterranean landscape.

Two towers of 18 heights with houses designed to live outside. Homes with 3 bedrooms, and with large terraces. Large common areas with gardens, swimming pool, paddle, children's area, gym and infinity pool with sea views. The kitchens are equipped with induction hob, extractor hood, electric oven and microwave oven. Preinstallation for washerdryer. Complete installation of ducted air conditioning, with cold and heat pump, by aerothermy. The apartments have a garage and a storage room. Prices from EUR 467,000.





















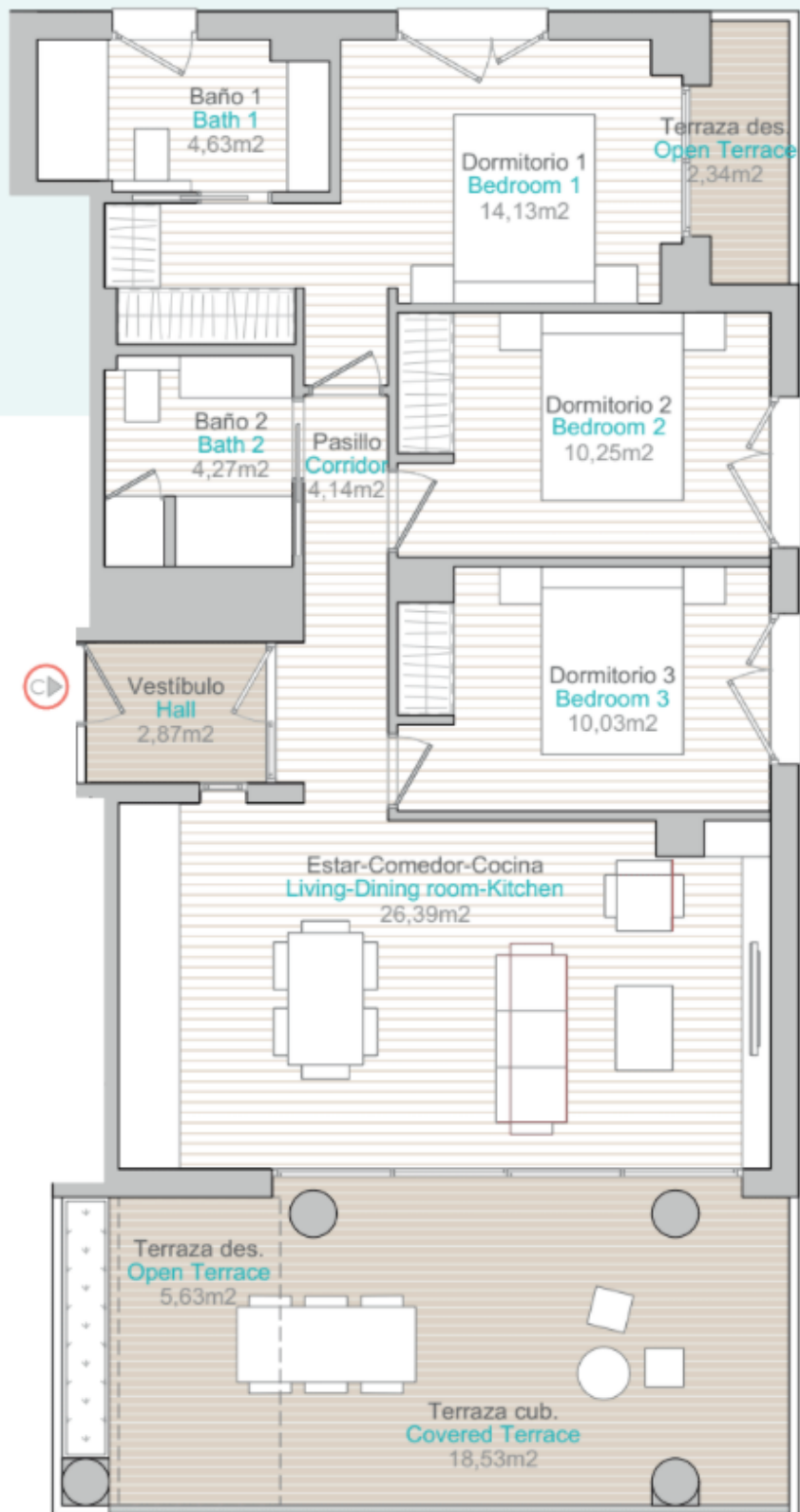

"OUR EXPERIENCE IS YOUR GUARANTEE"